

FIRST FLOOR PLAN
 REFERENCE



TOWN OF JONESBOROUGH, HAMPSHIRE
 COUNTY DEPARTMENT OF EDUCATION
**JONESBOROUGH
 SCHOOL**
 1000 Main Street
 Jonesborough, NH 03450

CLARKNEXSEN
 201 E. MAIN ST.
 CONCORD, NH 03301
 TEL: 603.224.1000
 WWW.CLARKNEXSEN.COM

NOT FOR CONSTRUCTION

DATE: 10/21/08
 90% CONSTRUCTION
 DOCUMENTS

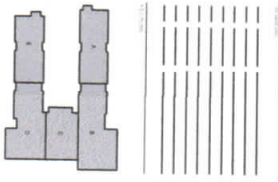

FIRST FLOOR REFERENCE
 PLAN

A101

DATE: 10/21/08
 90% CONSTRUCTION
 DOCUMENTS
 CN 9128

11 SECOND FLOOR PLAN
 1/8" = 1'-0"
 REF: 1101



TOWN OF JONESBOROUGH / WASHINGTON COUNTY DEPARTMENT OF EDUCATION
JONESBOROUGH SCHOOL
 123 Main Street
 Jonesborough, TN 37528

CLARKENSEN
 2000 WINDY LAKE
 JONESBOROUGH, TN 37528
 423.924.2400

NOT FOR CONSTRUCTION

30% BIDDING
 80% CONSTRUCTION
 DOCUMENTS

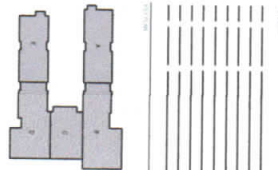

SECOND FLOOR REFERENCE PLAN

A102

CN 8/28

